

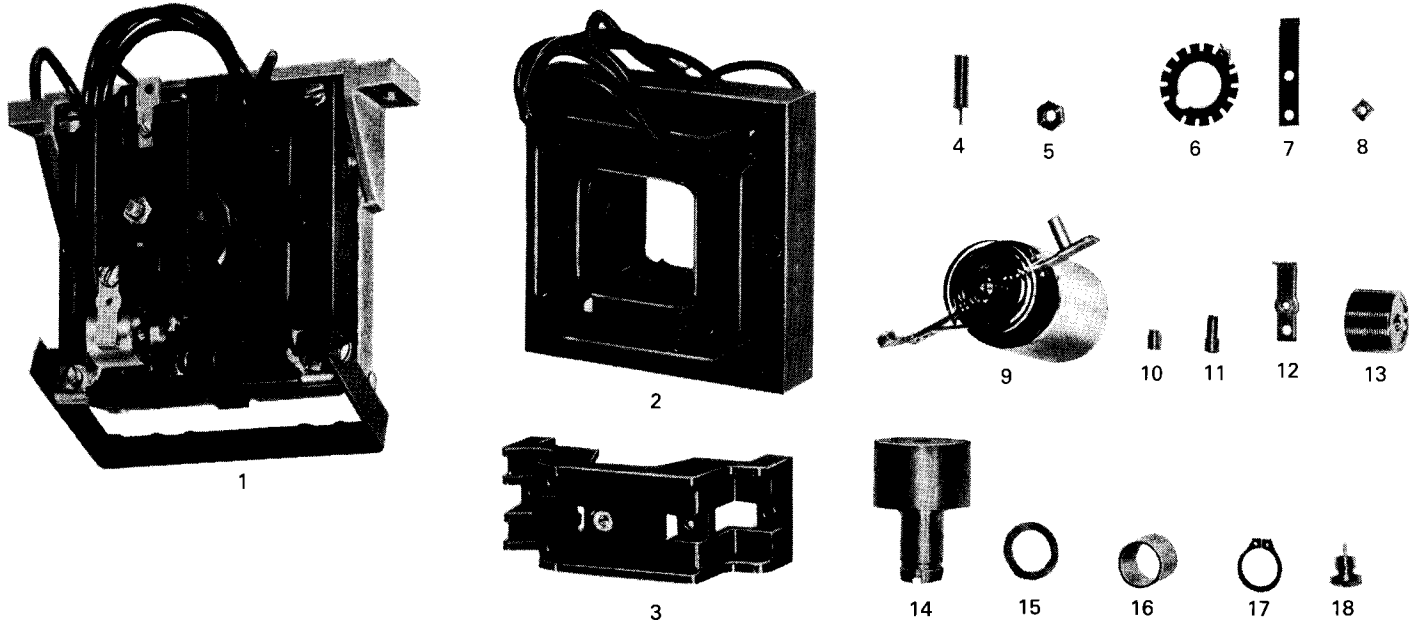

August, 1985
 Supersedes RPD 41-497A2 dated May, 1969
 Mailed to: E, D, C/41-400B

IN FT-42 Flexitest Case^①

Type KDTG Distance and Timer Relay



Complete Relay Style No.	Ohms	DC Volts	Frequency	Indicating Amps
670B032A09	1.5-30	125	60 Hz	1
670B032A10	1.5-30	250	60 Hz	1
670B032A11	1.5-30	48	60 Hz	1
670B032A12 ^③	1.5-30	48	60 Hz	1
670B032A13 ^③	1.5-30	125	60 Hz	1
670B032A14 ^③	1.5-30	250	60 Hz	1
670B032A15	1.5-30	125	50 Hz	1
670B032A16	1.5-30	250	50 Hz	1
670B032A17	1.5-30	48	50 Hz	1
670B032A18 ^③	1.5-30	48	50 Hz	1
670B032A19 ^③	1.5-30	125	50 Hz	1
670B032A20 ^③	1.5-30	250	50 Hz	1

Resistors Description	Resistor Style
20K Ohm 40W 3.5" Adjustable	1730 918 ^④
15K Ohm 40W 3.5" Adjustable	1730 913 ^④
10K Ohm 40W 3.5" Adjustable	1730 906 ^④
8.5K Ohm 40W 3.5" Adjustable	1730 903 ^④
5K Ohm 25W 2" Fixed	1205 214
3K Ohm 25W 2" Fixed	1202 954
2K Ohm 25W 2" Fixed	1267 296
1180 Ohm 25W 2" Fixed	1202 493
200 Ohm 25W 2" Fixed	1202 586
1K Ohm 2W	187A642H27
470 Ohm 1/2W	187A641H19

- ③ Contains timer locking tabs.
- ④ Two (2) used.
- ⑤ Used in 60 Hz styles.
- ⑥ Used in 50 Hz styles.

Cylinder Unit Parts Ref. No.	Description of Parts	Style Number
1	Cylinder Unit Complete	3498A47G14
2	Electromagnet	289B172G16★
3	Bridge and Insert	183A660G01
4	Upper Bearing Screw	3499A37G11
5	Nut for Upper Bearing Screw	203 056
6	Spring Adjuster	1730 950
7	Clamp for Spring Adjuster	1730 954
8	Nut for Spring Adjuster Clamp	1008 149
9	Moving Element, w/Contact and Spring, Less Adjuster	184A930G21★
10	Upper Bearing	289B392G01
11	Lower Bearing	289B392G02
12	Pressure Spring to Lock Stationary Contact	1730 953
13	Stationary Contact (Left Hand)	3491A82G09★
14	Core	292B405H01
15	Core Washer	837 754
16	Spacer	186A069H09
17	Core Retaining Clip	31D5056H03
18	Lower Bearing Screw	3499A37G01

NOTE: Parts indented are included under part which they are indented.
 ★ Recommended for stock.
 ① For flexitest case parts refer to RPD 41-076A1.

Ordering Information

- Give style number and name of part.
- Give the complete nameplate reading.
- State method of shipment desired.
- Send all orders or correspondence to nearest sales office of the company.

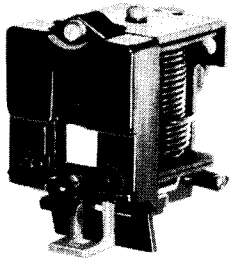

1, 2, 3



5



10

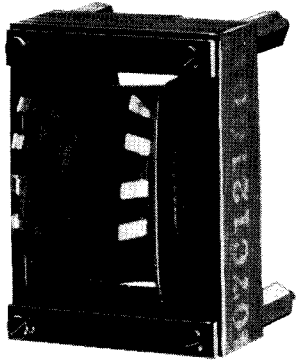

15, 16, 17

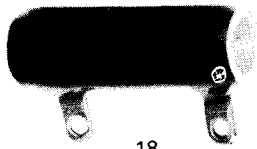

18

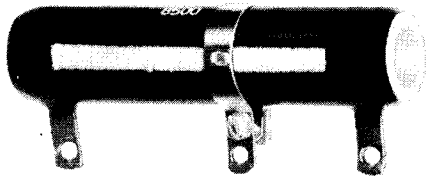

18



19



20



21, 22

Common Parts

Ref. No.	Description of Part	Style Number
1	Operation Indicator (Upper Lefthand Unit).....	3491A65G22②⑥★
2	Operation Indicator (Upper Righthand Unit).....	3491A65G28②⑥★
3	Operation Indicator (Lower Righthand Unit).....	3491A65G24②⑥★
Δ 4	Contact Switch (Lower Lefthand Unit).....	3491A28G18②⑦★
5	Stationary Contact for Contactor Switch.....	1732 868④★
Δ 6	Telephone Relay (Top Center Position)....	19B1312H12★
Δ 7	Telephone Relay (Rear Position).....	407C614H03★
Δ 8	Circuit Board.....	290B284G01★
Δ 9	Tap Plate.....	411C261G01
10	Tap Screw.....	1956 275
Δ11	Compensator and Socket Assembly, (TAB).....	411C091G06⑧★
Δ12	Compensator and Socket Assembly, (TBC).....	411C091G05⑧★
Δ13	Compensator and Socket Assembly, (TAB).....	411C091G10⑩★
Δ14	Compensator and Socket Assembly, (TBC).....	411C091G09⑩★
15	Pulsing Transformer.....	407C121G16★
16	Auto Transformer (SA), Left Position....	407C121G14★
17	Auto Transformer (SC), Right Position...	407C121G15★
18	Resistors.....	See Table★
19	Centering Washer for 3.5" Resistors.....	1202 559
20	Insulating Washer for 3.5" Resistors.....	1201 886
21	Capacitor 2mFD.....	14C9400H13★
22	Capacitor 1.23mFD.....	1877 963⑨★
Δ23	Diode, Power Regulator, (IN2989B).....	629A798H01★
Δ24	Diode, (1.5KE200).....	878A619H01⑤★
Δ25	Potentiometer, (T2), 40K Ohm.....	184A756H01★
Δ26	Potentiometer, (T3), 100K Ohm.....	184A756H02★
Δ27	Dial Lock for Relays w/Timer Lock Tabs..	187A962H01④
Δ28	Knob for Potentiometer.....	187A883H01④
Δ29	Knob for Potentiometer for Relay w/Timer Lock Tabs.....	187A744H01④

- ★ Recommended for stock.
- Δ Not illustrated.
- ② For operation indicator parts refer to RPD 41-852A1.
- ④ Two (2) used.
- ⑤ Three (3) used.
- ⑥ ICS unit without contacts.
- ⑦ ITT unit without scale and contact.
- ⑧ Used in 60 Hz styles.
- ⑨ Used in 50 Hz styles.

Printed in USA

