



IRT 501

FlexTrack : Material handling track motion

MAIN APPLICATIONS

Material handling

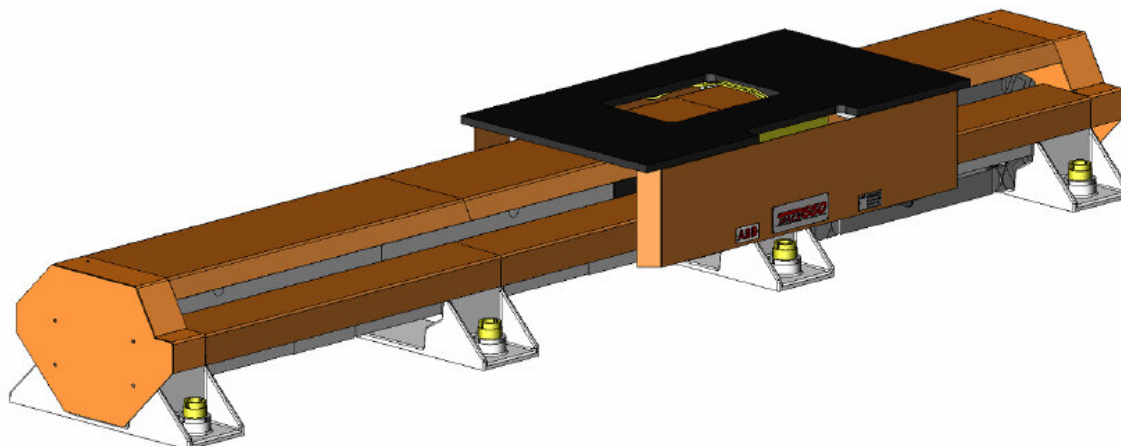

Benefits

- Compact design
- Easy to install – integrated levelling system
- Entirely protected – cable chain inside track
High modularity – variable length with 1m modules and one or few independent carriages
- No limitation of length and number of carriages
- Optimized use of the robot
- High repeatability
- High static stability on the carriage
- Heavy loads capacity
- Extends robot working range
- High speed and acceleration
- Robust design
- Low maintenance
- Patented technology (patent pending)

Applications

- Material handling
- Part conveying
- Spot welding
- Machine tending
- Arc welding
- Packing
- Palletizing
- Measuring
- Sealing
- Deburring
- Grinding
- Gluing
- Assembling

FlexTrack : Material handling track motion

Data	IRT 501-66	IRT 501-66R	IRT 501-90	IRT501-90R
Repeatability	+/- 0.1 mm	+/- 0.1 mm	+/- 0.1 mm	+/- 0.1 mm
Acceleration *	2.1 m/s ²	1.5 m/s ²	1.5 m/s ²	1.0 m/s ²
Travel Speed *	2 m/s	1.5 m/s	1.5 m/s	1.2 m/s ²
A	660	660	900	900
B	484	484	724	724
C	435	435	495	495
D	1050	525	1050	525
L	1770 + S x 1050			
Mass (kg)**	588 + 195 x S	628 + 235 x S	749 + 222 x S	801 + 274 x S
Maximum payload	900 kg	2000 kg	2000 kg	2950 kg
Robots capability:	IRB1400	IRB2400	IRB4400 IRB6600	IRB7600
* With maximum payload				
** S: Stroke				

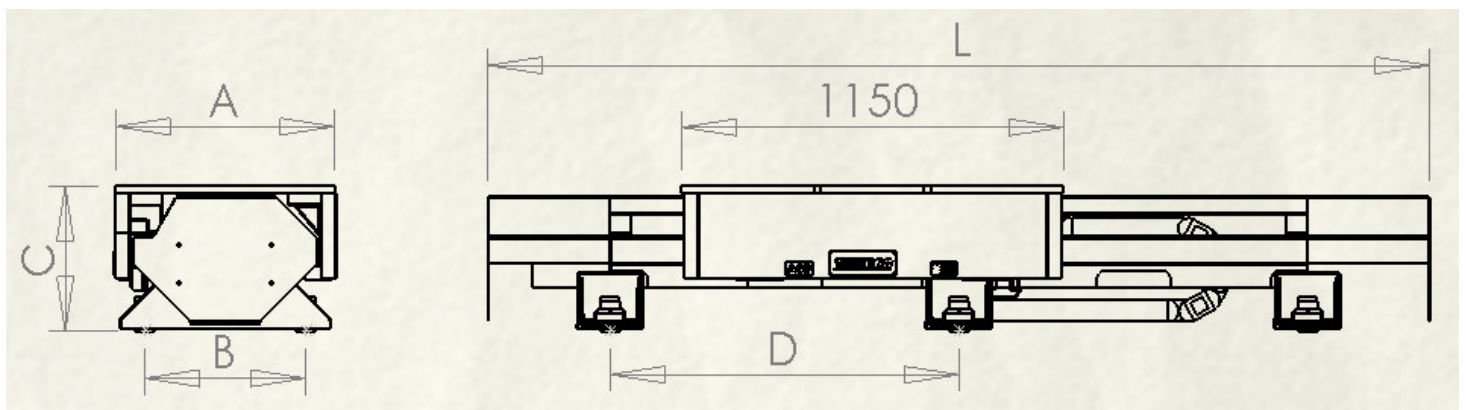

Base package

- IRT 501 FlexTrack minimum length 2.3 m
- One carriage
- Upper. lateral. side covers
- Parameter disk
- Documentation

Options

- Automatic lubrication system
- Additional carriages
- Electric working range limit switch
- Zone division for track motion
- SMB box
- Robot Cables 5 -10 - 15 m